

## Product Features

1. Energy Saving Technology.
2. Highly reliable constant current driver guarantees long life span of the lamp beads.
3. LED lights offer up to 85% saving in electricity cost compared to energy saver / halogen lamp and are designed to last for longer period.
4. Eco-Friendly, mercury free, lead free.
5. LED Track lights are compact, high efficiency and alternatives to conventional Task lighting & has excellent lighting performance.
6. Stainless Steel face board, die-cast aluminum & Fin Shell housing.
7. Dimmable model optional.
8. Available In: 3 / 5 / 7 / 10 / 12 / 15 / 25 / 30 / 60 Watt.
9. 2 year warranty.
10. OEM service available.

## Applications

Display Lighting, Task Lighting Etc.

## Notes

1. Operating temperature range between -20°C ~ +40°C
2. Use in dry indoor locations.
3. Don't use it with dimmers.



### Specifications

Order Code	CR-30011	
Model	CR-NX1-TRL	
Power	3W	
LED Description	3x1W	
LED	SMD	
LED Source	EDISON	
Luminous Flux	100~110 LM/W - (WW)	135~143 LM/W - (CW)
Lumen Maintenance	L80	
Color Temperature Available (± 200K)	2700~3300K	5500~6500K
Beam Angle	45°	
Input Voltage	90~265VAC, 50/60 Hz	
CRI	Ra≥80	
Working Temperature	-20°C ~ +40°C	
Humidity	10%~90%	
Material	Die Cast Aluminium	
Size (mm)	Ø44xL80	
Weight (approx)	250 gm	
Life	@Tj = 85 °C	50,000 hrs

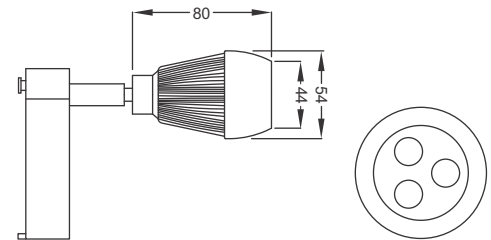

### Specifications

Order Code	CR-30012	CR-30013
Model	CR-NX2-TRL	
Power	5W	7W
LED Description	5x1W	7x1W
LED	SMD	
LED Source	EDISON	
Luminous Flux	100~110 LM/W - (WW)	135~143 LM/W - (CW)
Lumen Maintenance	L80	
Color Temperature Available (± 200K)	2700~3300K	5500~6500K
Beam Angle	45°	
Input Voltage	90~265VAC, 50/60 Hz	
CRI	Ra≥80	
Working Temperature	-20°C ~ +40°C	
Humidity	10%~90%	
Power Factor	≥0.9	
LED Driver	Isolated (THD ≤20%)	
Material	Die Cast Aluminium	
Size (mm)	Ø83xL200	
Weight (approx)	600 gm	
Life	@Tj = 85 °C	50,000 hrs

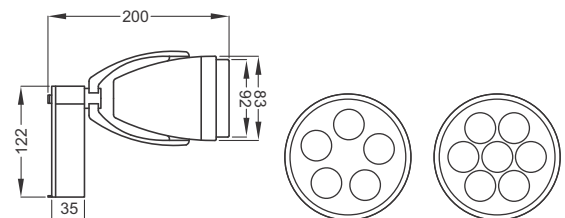

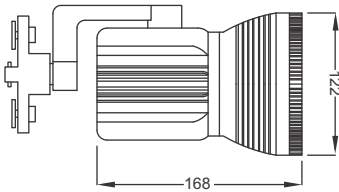

### Specifications

Order Code	CR-30014	
Model	CR-HUX-TRL	
Power	15W	
LED Description	15x1W	
LED	SMD	
LED Source	EDISON	
Luminous Flux	100~110 LM/W - (WW)	135~143 LM/W - (CW)
Lumen Maintenance	L80	
Color Temperature Available ( $\pm 200K$ )	2700~3300K	5500~6500K
Beam Angle	45°	
Input Voltage	90~265VAC, 50/60 Hz	
CRI	Ra $\geq$ 80	
Working Temperature	-20°C ~ +40°C	
Humidity	10%~90%	
Power Factor	$\geq$ 0.9	
LED Driver	Isolated (THD $\leq$ 20%)	
Material	Die Cast Aluminium	
Size (mm)	Ø122xL168	
Weight (approx)	1.1 kg	
Life	@Tj = 85 °C	50,000 hrs

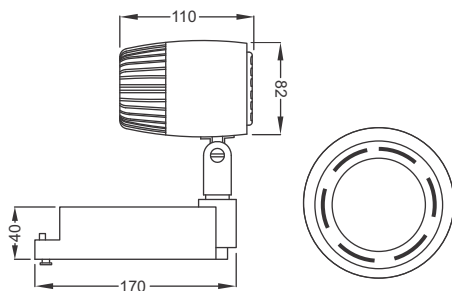

### Specifications

Order Code	CR-30015	CR-30016
Model	CR-TCO-TRL	
Power	10W	15W
LED Description	1x10W	1x15W
LED	COB	
LED Source	CREE	
Luminous Flux	80 LM/W - (WW)   85 LM/W - (CW)	109 LM/W - (WW)   117 LM/W - (CW)
Lumen Maintenance	L80	
Color Temperature Available ( $\pm 200K$ )	2700~3300K	5500~6500K
Beam Angle	25°	
Input Voltage	90~265VAC, 50/60 Hz	
CRI	Ra $\geq$ 80	
Working Temperature	-20°C ~ +40°C	
Humidity	10%~90%	
Power Factor	$\geq$ 0.9	
LED Driver	Isolated (THD $\leq$ 20%)	
Material	Die Cast Aluminium	
Size (mm)	Ø82xL110	
Weight (approx)	800 gm	
Life	@Tj = 85 °C	50,000 hrs



### Specifications

Order Code	CR-30017	
Model	CR-TCO-TRL	
Power	25W	
LED Description	1x25W	
LED	COB	
LED Source	CREE	
Luminous Flux	107 LM/W - (WW)	113 LM/W - (CW)
Lumen Maintenance	L80	
Color Temperature Available ( $\pm 200K$ )	2700~3300K	5500~6500K
Beam Angle	25°	
Input Voltage	90~265VAC, 50/60 Hz	
CRI	Ra $\geq$ 80	
Working Temperature	-20°C ~ +40°C	
Humidity	10%~90%	
Power Factor	$\geq$ 0.9	
LED Driver	Isolated (THD $\leq$ 20%)	
Material	Die Cast Aluminium	
Size (mm)	$\varnothing$ 92xL125	
Weight (approx)	900 gm	
Life	@T <sub>J</sub> = 85 °C	50,000 hrs

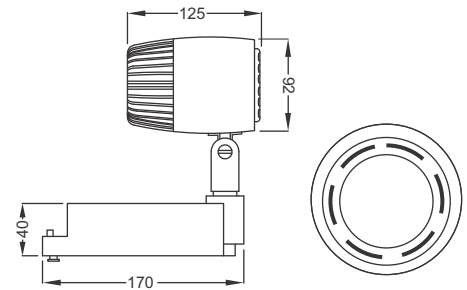

### Specifications

Order Code	CR-30018	
Model	CR-MON-TRL	
Power	30W	
LED Description	1x30W	
LED	COB	
LED Source	CREE	
Luminous Flux	98 LM/W - (WW)	104 LM/W - (CW)
Lumen Maintenance	L80	
Color Temperature Available ( $\pm 200K$ )	2700~3300K	5500~6500K
Beam Angle	25°	
Input Voltage	90~265VAC, 50/60 Hz	
CRI	Ra $\geq$ 80	
Working Temperature	-20°C ~ +40°C	
Humidity	10%~90%	
Power Factor	$\geq$ 0.9	
LED Driver	Isolated (THD $\leq$ 20%)	
Material	Die Cast Aluminium	
Size (mm)	$\varnothing$ 97xL127	
Weight (approx)	1 kg	
Life	@T <sub>J</sub> = 85 °C	50,000 hrs

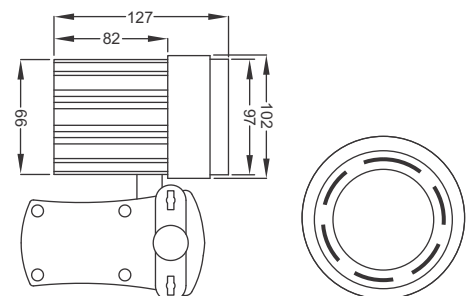



Anti-aging housing

PC/ABS anti-aging housing, making sure the lamp will be protected from corrosion and color fading in bad conditions like humidity or high-temperature.



Hook up connection structure

Hook up structure, easy to assemble, efficient for mass production.



360° adjustment angle for lighting

360° +216° adjustment points for all around lighting.



Shark gill bionic design

Innovative air-duct channel, shark gills shaped optimize airflow efficiency, the "shark gills" zero resistance airduct design by clothing, fabric.



High-efficient double ball-bearing fan

High efficient two ball bearing fan, expand its life span up to 60,000 hours, Noise is less than 26 dB, fault warning with automatic alarm system and intelligent power off.



Cooling fin structure

Innovative fin-style design, adopt high-thermal conductive material AL1060, Crest patented technologies including zippered-fin, cooling area for super heat dissipation.



Black/white (optional)

Two color optional, matching with black/white ceiling, making the light body invisible.



## Specifications

Order Code	CR-30019		CR-30020	
Model	CR-GD-TRL			
Power	30W		60W	
LED Description	18Pcs		30Pcs	
LED	SMD			
LED Source	CREE			
Luminous Flux	104 LM/W - (WW)	119 LM/W - (CW)	99 LM/W - (WW)	112 LM/W - (CW)
Color Temperature Available (+ 200K)	2700~3300K	5500~6500K	2700~3300K	5500~6500K
Optional LED Source Available EVERLIGHT	98 LM/W - (WW)	113LM/W - (CW)	94 LM/W - (WW)	106 LM/W - (CW)
Lumen Maintenance	L80			
Beam Angle	30°		35°	
Input Voltage	90~265VAC, 50/60 Hz			
CRI	Ra>80			
Working Temperature	-20°C ~ +40°C			
Humidity	10%~90%			
Power Factor	≥0.9			
LED Driver	Isolated (THD ≤20%)			
Material	Fin Shell (6063) Aluminium, (With Cooling Fan)			
Size (mm)	Ø95x127		Ø120xH143	
Weight (approx)	700 gm		1 kg	
Life	@Tj = 85 °C, 50,000 hrs			

